

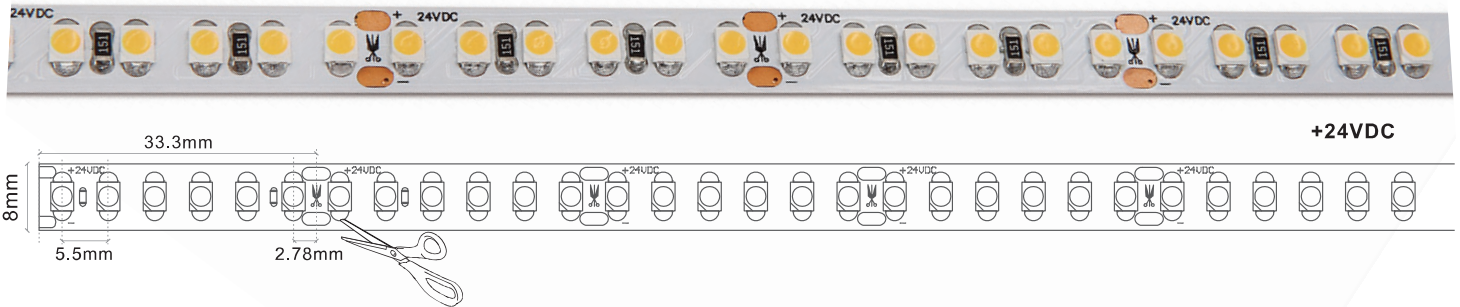

Addicted to light!

# LED STRIP LIGHT SERIES

## VL-L3528/180-14.4W/M



14.4W/m LED strip with adhesive backing, 180 chips per metre for dot-free homogenous lighting. Available in 2700K, 3000K and 4000K colour temperatures. 3.3cm cut increments.

IP20: Standard use, dry areas  
 IP54: Protection from splashing water, use in wet areas and for outdoor installations  
 IP67: Protection from submersion in water

<b>1,026</b> <b>1,026</b> <b>1,100</b> LUMENS	<b>14.4W</b> WATT	<b>2700K</b> <b>3000K</b> <b>4000K</b> COLOUR	<b>IP20</b> <b>IP54</b> <b>IP67</b> IP RATING
<b>24V</b> DC	<b>120°</b> BEAM ANGLE	<b>5 YEARS</b> WARRANTY	<b>SINGLE</b> ROW

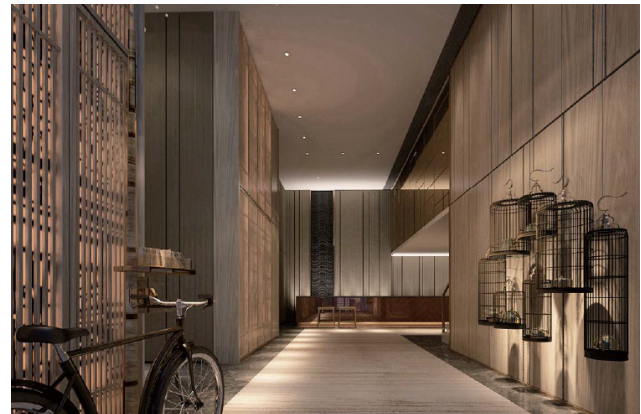

Model	IP Rating	Power (W)	Lumen Output (lm)	CCT	CRI	Beam Angle	Dimming	Dimensions	Cuttable (cm)	Row Type	Voltage	Chips Per M
VL-L3528/180-14.4W/M	IP20 IP54 IP67	14.4W/M	1,026lm 1,026lm 1,100lm	2700K 3000K 4000K	≥90	120°	Dimmable	8mm	3.3cm	Single Row	24V DC	180